





Product Highlights

- Intense illumination in a compact (116.84mm Dia.) housing
- IP67 compliant design; washdown capabilities
- Axial light source designed for inspecting non-specular objects



General Specifications

| | Color | 24v Current | All Other Controls |
|--|---|-------------|--------------------|
| Electrical Specifications | 365, 375, 385, 395, 405 | 0.48 A | 0.53 A Max |
| | 455, 470, 530, WHI | 0.48 A | 0.48 A Max |
| | 590, 625 | 0.24 A | 0.50 A Max |
| | 850, 940 | 0.48 A | 0.60 A Max |
| Normal Operating Temperature | 0 - 60°C | | |
| Weight (g) | 308 g (10.9 oz) | | |
| Standard Cable Information | Up to 2 meters (80") long - 105°C rated PVC jacket, foil shield with drain. | | |
| Photobiological Risk Factor IEC 62471 | Exempt Applicable Wavelengths: 850, 940 Group 1 (Low-Risk) Applicable Wavelengths: 455, 470, 530, 590, 625, WHI Group 2 (Moderate Risk) Applicable Wavelengths: 365, 375, 385, 395, 405 | | |
| Compliance |    | | |
| IP Rating | IP67 | | |
| Lumen Maintenance | L70 = 50,000 hours | | |

Mechanical Specifications

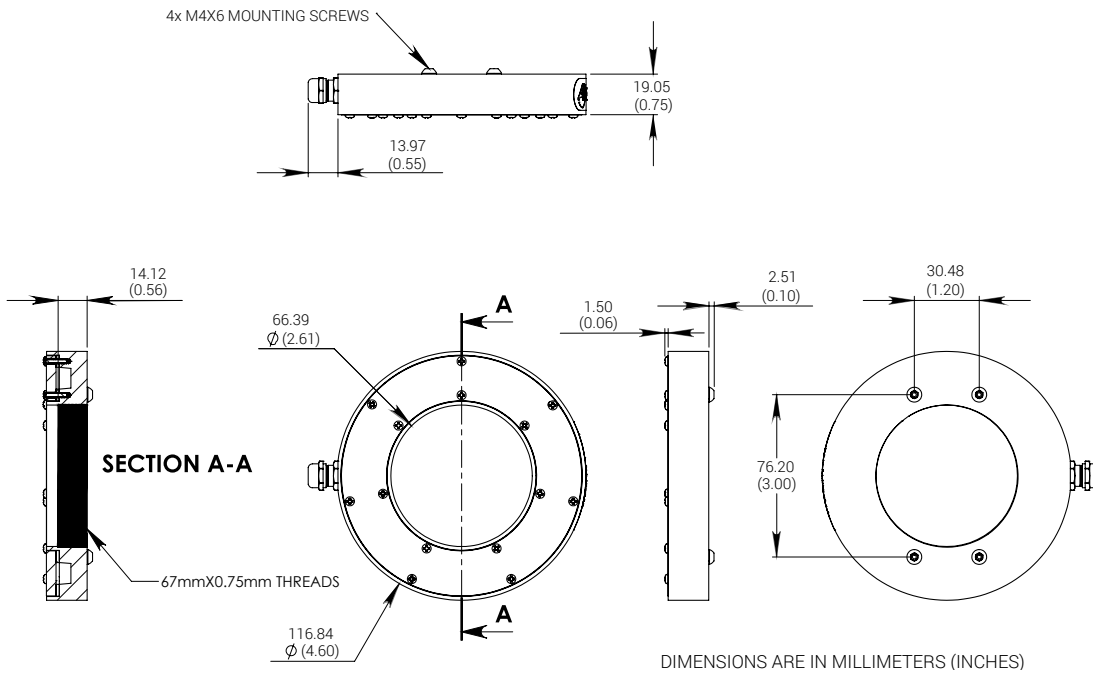

Part Number Key

| Model | — | Spectral Wavelength | Connector/ Control | Optional Light Conditioning | — | Alternative Connector |
|--------------------------------------|---|---|-----------------------------------|--|---|-----------------------|
| RL127 | — | XXX | XX | X | — | XXX |
| RL127 | | (UV) 365 (UV) 375 (UV) 385 (UV) 395 (violet) 405 (royal blue) 455 (blue) 470 (green) 530 (amber) 590 (red orange) 625 (infra-red) 850 (infra-red) 940 (white) WHI | C1 C5 IC I3 I3S 24 | D ² (diffuser) P ² (polarizer) | | M12 ¹ |
| Ex: RL127-470C5D RL127-WHI24P-M12 | | | | ¹ Available with IC, I3, I3S and 24 options only ² Not available with UV option (blue) 470 will reduce the life of the polarizer | | |

Stock Product: shipped within 3 days **Build to Order:** shipped within 2 weeks
RL127-WHIIC

Connector | Control Options

| C1 Connector | C5 Connector | ICS 2 (IC) | ICS 3 (I3) | ICS 3S (I3S) | 24 |
|--|---|---|---|---|--|
| For use with: DCS Series Controllers | For use with: Pulsar 320 Strobe Controller. | Continuous in-line controller Powered with: 24V power supply | Combination strobe/continuous in-line controller Powered with: 24V power supply | Default-OFF strobe/continuous in-line controller Powered with: 24V power supply | Flying/tinned leads Powered with: 24V power supply |

Optical Performance

Intensity Distribution

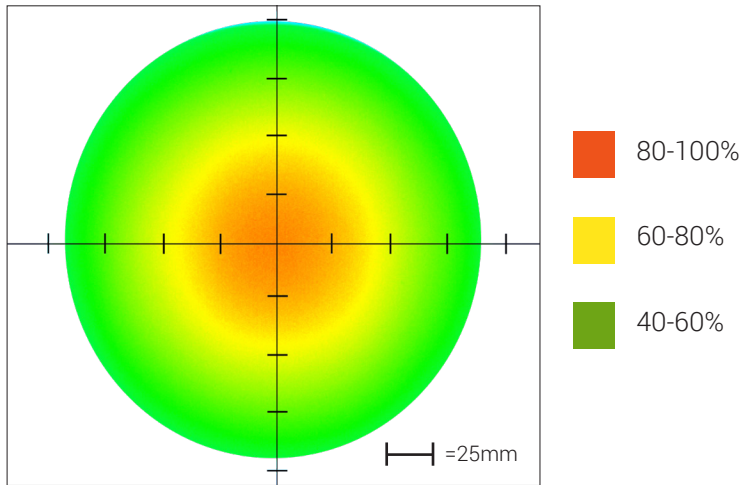

Optical measurement taken using RL127-WHIC @ 200 mm

Area of Illuminance & Intensity

Working Area (FWHM)
@ Working Distance

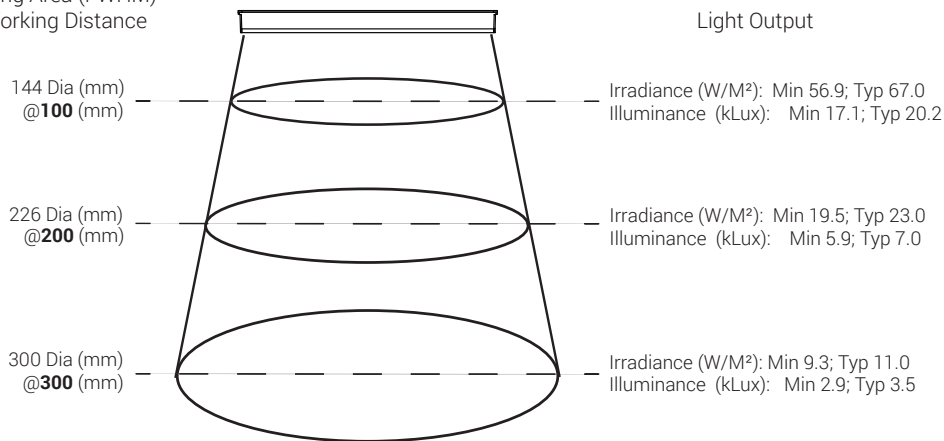

Operation and Wiring

ICS 2 (IC)

| Pin (M12) | Function | Wire Color |
|-----------|----------------------------|------------|
| 1 | +24 VDC | Brown |
| 2 | 0-10 VDC Analog Control | White |
| 3 | GND | Blue |
| 4 | GLO | Black |
| 5 | N/A | Gray |

ICS 3 (I3 and I3S)

| Pin (M12) | Function | Wire Color |
|-----------|----------------------------|------------|
| 1 | +24 VDC | Brown |
| 2 | Reserved | White |
| 3 | GND | Blue |
| 4 | PNP/Active High Trigger | Black |
| 5 | 0-10 VDC Analog Control | Gray |

24 Volt

| Pin (M12) | Function | Wire Color |
|-----------|----------|------------|
| 1 | +24 VDC | Brown |
| 2 | N/A | White |
| 3 | -24 VDC | Blue |
| 4 | N/A | Black |
| 5 | N/A | Gray |

Optional M12 Pinout

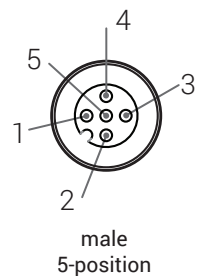

Warranty Information

Every Advanced illumination, Inc. (Ai) product is thoroughly inspected and tested before leaving the factory. Products are warranted to be free of defects in workmanship and materials for a period of two years from the original date of purchase. Should a defect develop during this period, please contact Ai Customer Service or your Ai distributor for a Return Merchandise Authorization (RMA), and return the complete product, freight prepaid, to Ai. If a defect is found, Ai will - at our discretion - repair or replace the product without charge. Ai claims no liability for any implied warranties, including "merchantability" and "fitness for a specific purpose."

Electromagnetic Compatibility

This product was tested and complies with the regulatory requirements and limits for electromagnetic compatibility (EMC) as stated in the product specifications. These requirements and limits are designed to provide reasonable protection against harmful interference only when the product is operated in its intended industrial electromagnetic environment. To minimize the potential for electromagnetic interference or unacceptable performance degradation, install and use this product in strict accordance with the instructions in the product documentation.

Customer Service

For information on existing orders, or to make an order adjustment, contact us Monday through Friday 8:00 am to 5:00 pm, EST or send an email to orders@advill.com.

Company Information

Advanced Illumination

440 State Garage Road, Rochester VT. 05767

Phone: 802.767.3830

Fax: 802.767.3831

Email: info@advancedillumination.com

Web: advancedillumination.com

© 2015 Advanced Illumination Inc. All rights reserved