

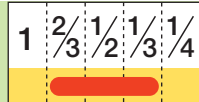

**For FA/Machine Vision**  
**Fixed Focal**

# HF25HA-1B

Applicable camera (model)



**FIXED**  
Fixed Focal

**TELE**  
Telephoto Long Focal

**1.5 Mega**  
For Megapixel Camera

**MANUAL**  
Manual Iris

**C-mnt**  
C Mount

**METAL**  
Metal Mount

**F1.4**  
Wide Aperture Rate



- High-resolution design, providing support for up to 1.5 megapixel camera resolution.
- Low-distortion design achieving accurate image input.
- Compact, lightweight and robust design, supporting various systems.
- Focus & iris lock tab provided, supporting environments such as vibration.

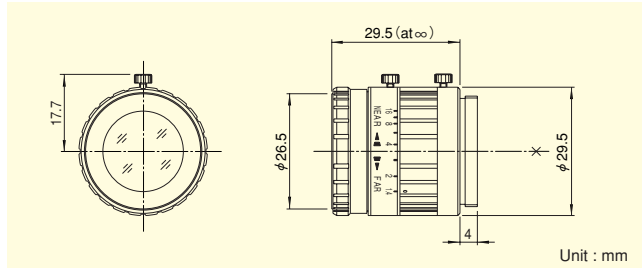

Focal Length (mm)		25
Iris Range		F1.4 ~ F16
Operation	Focus	Manual
	Iris	Manual
Angle Of View (H×V)	2/3"	19°58' × 15°02'
	1/2"	14°35' × 10°58'
	1/3"	10°58' × 8°14'
Focusing Range (From Front Of The Lens) (m)		∞ ~ 0.15
Object Dimensions at M.O.D. (H×V) (mm)	2/3"	53 × 40
	1/2"	38 × 29
	1/3"	29 × 22
Back Focal Distance (in air) (mm)		14.58
Exit Pupil Position (From Image Plane) (mm)		-32
Filter Thread (mm)		M25.5 × 0.5
Mount		C
Mass (g)		45

- Remarks**
- With Metal Mount
  - With Locking Knob for Iris and Focus



**For FA/Machine Vision**  
**Fixed Focal**

# HF35HA-1B

Applicable camera (model)

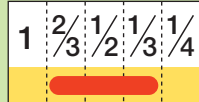

**FIXED**  
Fixed Focal

**TELE**  
Telephoto Long Focal

**1.5 Mega**  
For Megapixel Camera

**MANUAL**  
Manual Iris

**C-mnt**  
C Mount

**METAL**  
Metal Mount

**F1.6**  
Wide Aperture Rate



- High-resolution design, providing support for up to 1.5 megapixel camera resolution.
- Low-distortion design achieving accurate image input.
- Compact, lightweight and robust design, supporting various systems.
- Focus & iris lock tab provided, supporting environments such as vibration.

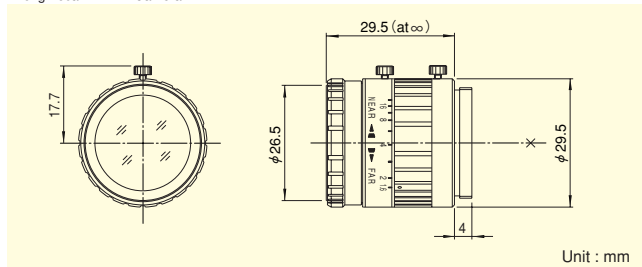

Focal Length (mm)		35
Iris Range		F1.6 ~ F22
Operation	Focus	Manual
	Iris	Manual
Angle Of View (H×V)	2/3"	14°20' × 10°46'
	1/2"	10°27' × 7°51'
	1/3"	7°51' × 5°53'
Focusing Range (From Front Of The Lens) (m)		∞ ~ 0.25
Object Dimensions at M.O.D. (H×V) (mm)	2/3"	59 × 44
	1/2"	43 × 32
	1/3"	32 × 24
Back Focal Distance (in air) (mm)		15.03
Exit Pupil Position (From Image Plane) (mm)		-27
Filter Thread (mm)		M25.5 × 0.5
Mount		C
Mass (g)		45

- Remarks**
- With Metal Mount
  - With Locking Knob for Iris and Focus